

INVISIRAIL™ Glass Gate Installation Instructions

GLASS RAIL SYSTEM

Post / Wall Mounted Hinges

1) Install the gate hinges onto the gate glass panel, with the hydraulic control hinge as the bottom hinge.

The hydraulic hinge can be identified by the set screw valves to adjust the closing speed of the hinge.

Do not yet remove the white plastic retaining block on the hydraulic hinge.

2) Position the glass panel with hinges on the post such that the top of glass is at the required rail height and/or at the same height as the other railing panels. At this position, mark on the post where the fasteners for the hinges should be drilled.

3) Use fasteners to install hinges on the post. Pre-drill holes if necessary.

4) Once the panel is mounted on the post, remove the plastic retaining block on the hydraulic hinge.

5) Check if the post is plumb with the weight of the glass panel. If not, install shims underneath the post base to plumb post.

Skip to SINGLE GATE, (Steps a, b, c) to complete installation of your single glass gate.

Skip to DOUBLE GATE, (Steps i – vi) to complete installation of your double glass gate.

SINGLE GATE

a. Install the pull-pin latch onto the Operating Gate Panel using the two small bolts to fasten the assembly through the two holes in the glass.

b. Install the post-mounted latch keeper on the post to line up with the glass-mounted latch.

c. Once all gate components are installed, adjust the hinge closing speed by turning the valve control screws located on the hinge (see page x). Make small incremental turns to the screws to adjust the closing speed.

WARNING: Over turning screws can lead to hinge malfunction. Ensure the gate closes gently without slamming. Test several times to ensure successful operation.

DOUBLE GATE

i. Repeat Steps 1-5 to install the Semi-Fixed Glass Gate panel on the post.

ii. Install the pull-pin latch onto the Operating Gate Panel using the two small bolts to fasten the assembly through the two 3/8" holes in the glass.

iii. Install the magnetic, glass-mounted latch keeper onto the Semi-Fixed panel using the set screws (not through bolted onto glass). Ensure the foam side of the loose metal plate is against the glass before tightening the set screws.

iv. Install the dropleg bolt onto the Semi-Fixed Glass Panel.

v. Once both gate panels are installed, ensure they line up with each other when closed and mark the position of the dropleg bolt on the deck surface. Drill a 1/2" hole in the deck for the bolt to slide into. The dropleg contains holes that allow the bolt to be "locked" in the down position if necessary.

vi. Once all gate components are installed, adjust the hinge closing speed by turning the valve control screws located on the hinge (see page x). Make small incremental turns to the screws to adjust the closing speed.

WARNING: Over turning screws can lead to hinge malfunction. Ensure the gate closes gently without slamming. Test several times to ensure successful operation.

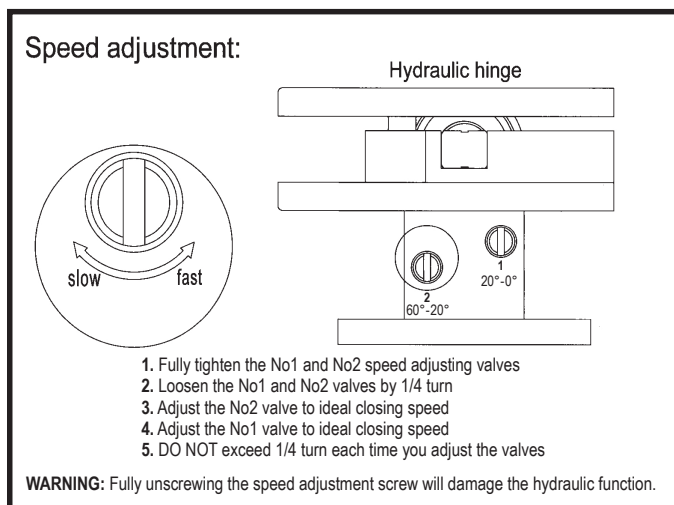

SINGLE GATE

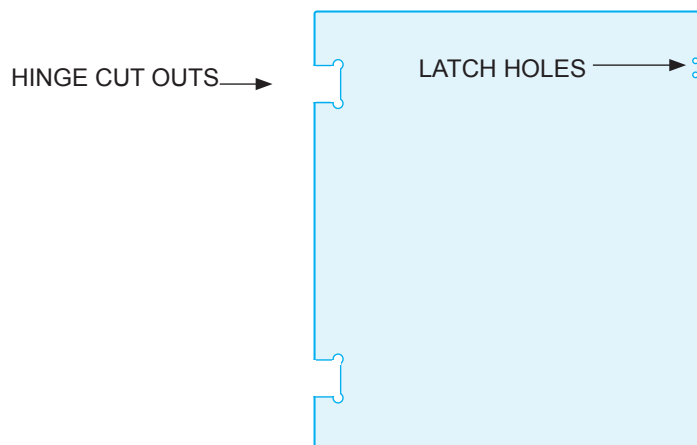
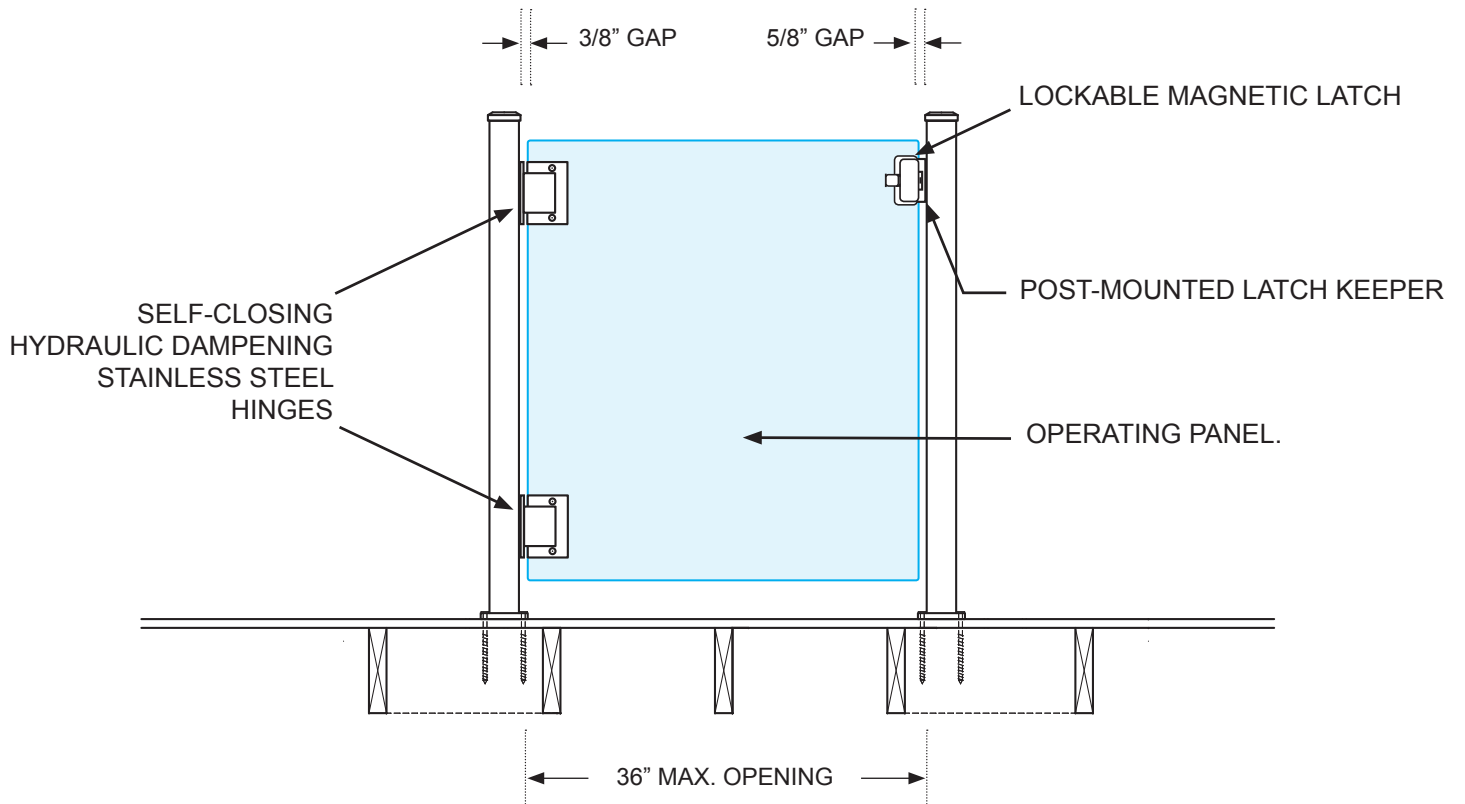

ALL PANELS TO BE 10MM TEMPERED AND HEAT SOAKED GLASS IN ACCORDANCE WITH CAN/CGSB-12.1-M. POLISHED EDGES, DUBBED CORNERS. SIZING AS PER CUSTOMER SUPPLIED MEASUREMENTS.

DOUBLE GATE

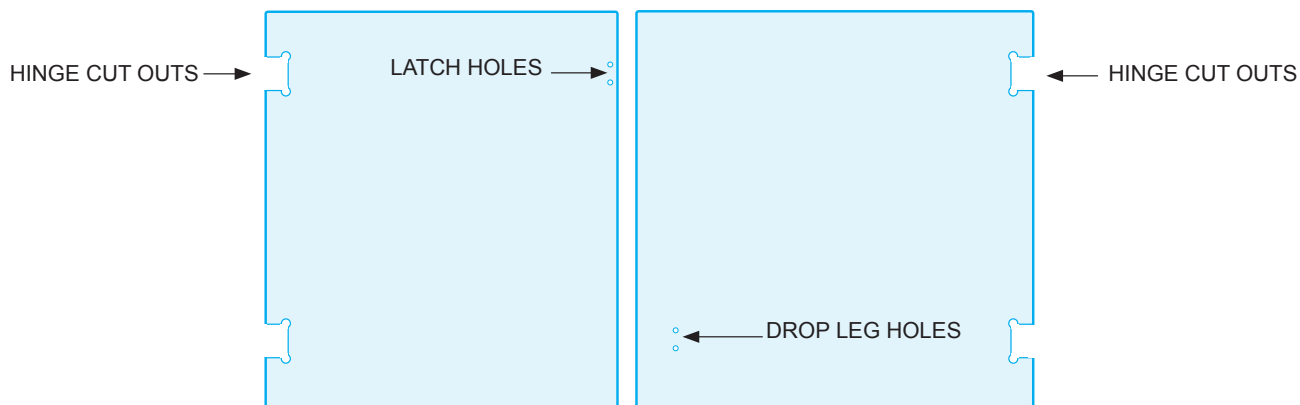
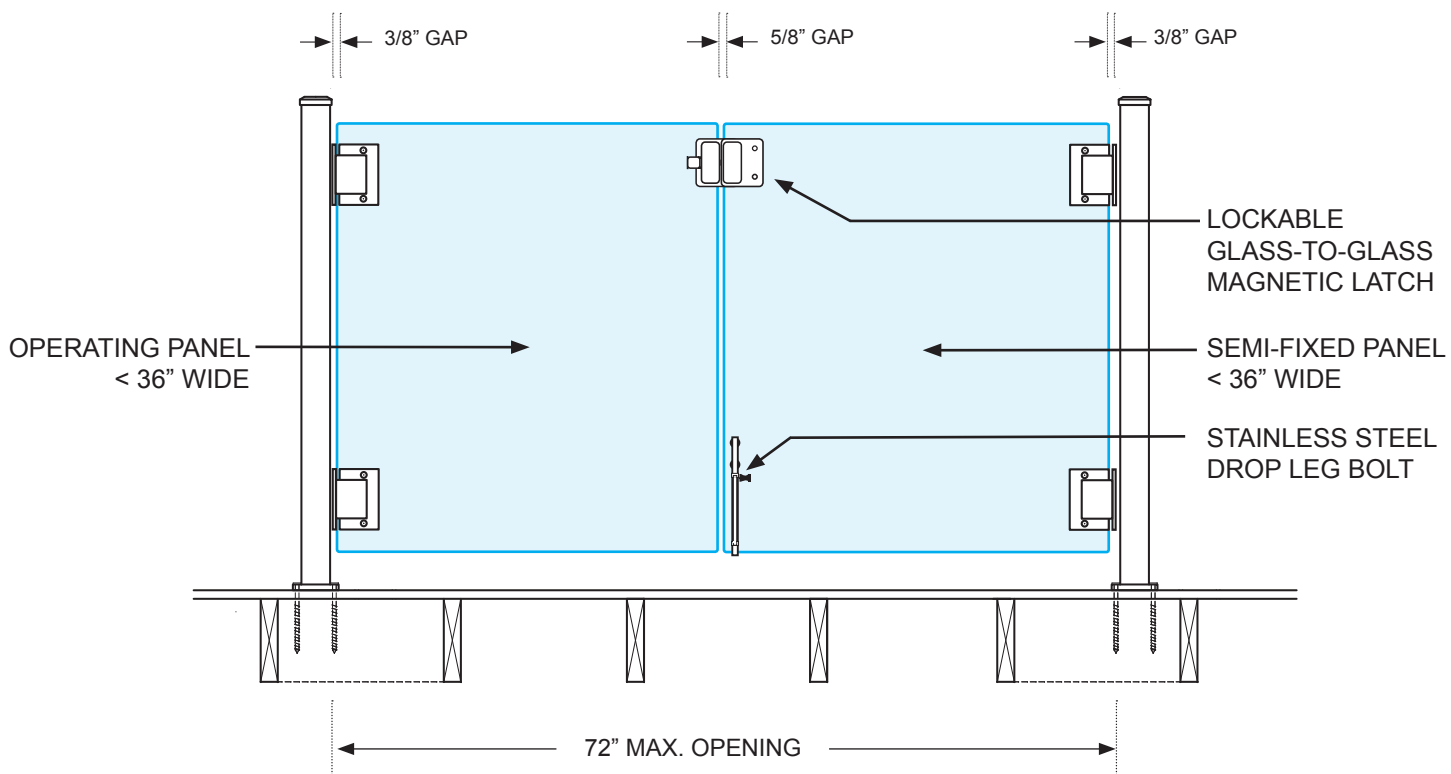

ALL PANELS TO BE 10MM TEMPERED AND HEAT SOAKED GLASS IN ACCORDANCE WITH CAN/CGSB-12.1-M. POLISHED EDGES, DUBBED CORNERS. SIZING AS PER CUSTOMER SUPPLIED MEASUREMENTS.